

3 lots
 { 1) PART 2 = .42 acre
 2) PART 4 = .42 acre
 5) PART 5 = .44 acre
 = 1.28 acres



PLAN AND FIELD NOTES
 OF SURVEY OF
 PARTS OF LOT 37 AND LOT 38, CONCESSION XI
 TOWNSHIP OF MURKORA
 DISTRICT OF MURKORA
 SCALE - 1 INCH = 100 FEET
 SURVEYOR - D. W. GARDNER, O.S.S.
 SURVEY COMPLETED 1963

SURVEYOR'S CERTIFICATE
 I hereby certify:
 1) That this survey and plan are correct and in accordance with the Survey's Act and the Land Titles Act and the regulations made thereunder;
 2) That I was present at and did personally supervise the survey represented by this plan;
 3) That this plan contains a true copy of the field notes of survey;
 4) That the survey was completed on the 18th day of August 1963.

Despatched 30th 1963
 D. W. Gardner
 O.S.S.
 (Signature)

LEGEND
 Monument found one as noted
 O.P.E.S.I.C. denotes iron square from bar by 21mm
 long fitted with an aluminum identifying
 marker as planned
 ● P.L.E.D. denotes 10mm x 10mm sharp marked
 together with a 3/4 egg weighted and
 demagnetized flush in a drill hole in rock
 Measurements shown on this plan are in
 feet and decimal parts thereof.

NOTE
 Bearings on this plan are
 astronomic and were derived from the
 N.T.S. of the South limit of Highway
 as shown on Department of Highways
 Plan P-1863-2, registered as No. 50794

PLAN BAO 86
APPROVED BY
RE-ENTERED AS
1-E-1
DATE
RECORDED ON
BY
LAST MAILED

The information contained in this plan is from sources believed to be reliable. However, it may be incorrect. This plan is not a warranty or representation.

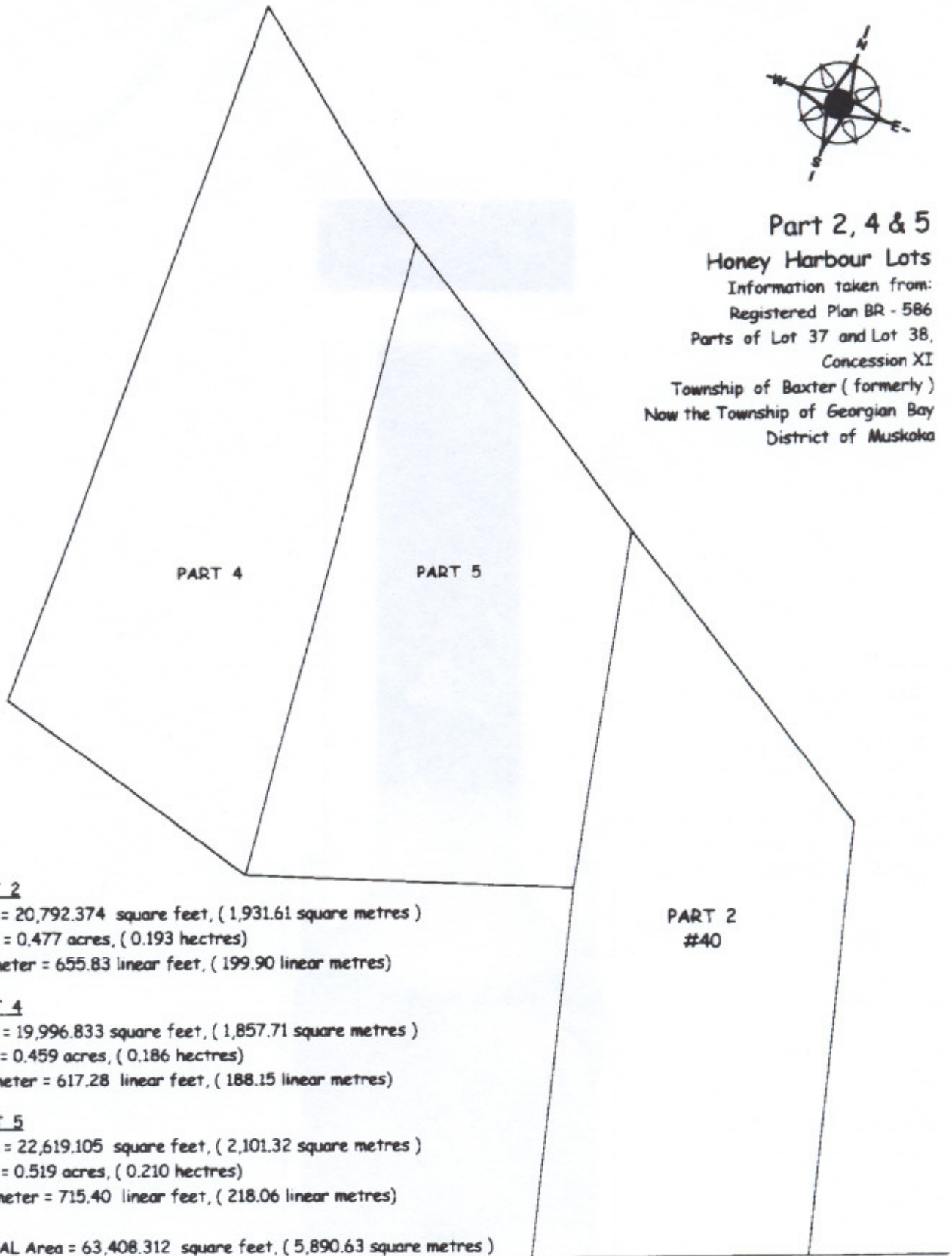

Part 2, 4 & 5
Honey Harbour Lots
Information taken from:
Registered Plan BR - 586
Parts of Lot 37 and Lot 38,
Concession XI
Township of Baxter (formerly)
Now the Township of Georgian Bay
District of Muskoka

PART 2
Area = 20,792.374 square feet, (1,931.61 square metres)
= 0.477 acres, (0.193 hectares)
Perimeter = 655.83 linear feet, (199.90 linear metres)

PART 4
Area = 19,996.833 square feet, (1,857.71 square metres)
= 0.459 acres, (0.186 hectares)
Perimeter = 617.28 linear feet, (188.15 linear metres)

PART 5
Area = 22,619.105 square feet, (2,101.32 square metres)
= 0.519 acres, (0.210 hectares)
Perimeter = 715.40 linear feet, (218.06 linear metres)

TOTAL Area = 63,408.312 square feet, (5,890.63 square metres)
= 1.456 acres (0.589 hectares)

LOT AREA CALCULATIONS
Scale : 1 inch = 50 feet
Oct 16, 2007

Picnic Island Road